

# The Garden Path

*Healing Gardens*

April/May 2023





3	Letter from the CEO <i>Steve Bloom</i>
4	Membership News <i>Updates &amp; Upcoming Events</i>
6	Feature <i>The Healing Power of a Garden</i>
8	60th Anniversary Special <i>A Letter from Kinya Hira, Garden Director (1964-69)</i>
10	Garden Update <i>Garden Leaders Awarded</i>
12	Japan Institute <i>Campus Explained</i>
14	Golden Crane Society
18	Photo Gallery
20	Did You Know...?

HAIKU
Gusts of wind; the rain The old lantern gathering its cherry blossoms
– Peter Kendall
SENIOR STAFF
CHIEF EXECUTIVE OFFICER Steve Bloom
DEPUTY DIRECTOR Cynthia Johnson Haruyama
THE ARLENE SCHNITZER CURATOR OF CULTURE, ART, AND EDUCATION Aki Nakanishi
CHIEF CURATOR AND DIRECTOR OF THE INTERNATIONAL JAPANESE GARDEN TRAINING CENTER Sadafumi Uchiyama
GARDEN CURATOR Hugo Torii
CHIEF EXTERNAL AFFAIRS OFFICER Lisa Christy
CHIEF FINANCIAL OFFICER Diane Freeman
DIRECTOR OF OPERATIONS Jason Sipe
DIRECTOR OF GUEST EXPERIENCE Stephan Ferreira
DIRECTOR OF BUYING & MERCHANDISING Ashley McQuade
EXECUTIVE ASSISTANT TO THE CEO Kathy Parmenter
DIRECTOR OF INTERNATIONAL EXCHANGE FORUM Paula Esguerra
CURATOR EMERITA Diane Durston
BOARD OF TRUSTEES
PRESIDENT Drake Snodgrass
PRESIDENT-ELECT Paul Schommer
VICE PRESIDENTS Doug de Weese, Cal Tanabe
TREASURER Jeff Wolfstone
SECRETARY Trish Adams
MEMBERS Jim Coonan, Bart Eberwein, Katherine Frandsen, Sally Gibson, Ronna Hoffman, Tatsuo Ito, Janelle Jimerson, Yoshio Kurosaki, Naoki Kuze, Polly Lauser, Martin Lotti, Paul Loving, Travers Hill Polak, Sue Reynolds, Cathy Rudd, Mark Stell, John Tarpey, Dorie Vollum, Dan Schwoerer, Alice Wiewel, Robert Zagunis
TRUSTEE EMERITA Maggie Drake
FOUNDATION BOARD
CHAIR Dee Ross
PRESIDENT Steve Bloom
VICE PRESIDENT Dede DeJager
SECRETARY/TREASURER Diane Freeman
MEMBERS Sandy Chandler, Greg Fitz-Gerald, Katherine Frandsen, James D. Lynch, Allen Mercer, Valerie Sasaki, Cal Tanabe, Cecelia Tanaka, Carmen Wong
THE GARDEN PATH
FOR QUESTIONS OR COMMENTS Email <a href="mailto:marketing@japanesegarden.org">marketing@japanesegarden.org</a>





📷 Christina Sjogren

Dear Members,

Spring has finally arrived! These are the weeks where we prepare the Garden for the many people who will visit in the coming months from all over the world, seeking inner peace or connection with nature, and everything in between.

I'd like to invite each of you to attend our Annual Membership Meeting on April 24th. Each year at this meeting we share updates on the Garden and Japan Institute, elect Trustees to our Board, and enjoy the friendship of fellow members! Special to this year's Membership Meeting will be the dedication of the "*Nezu Gate*." Previously known as the "Entry Gate" because it served as the main entrance to the Garden before the 2017 expansion, the newly named *Nezu Gate* has been a passageway millions of visitors have stepped through since its construction in the 1960s. This naming will be in honor of Koichi and Mihoko Nezu, founding members of our International Advisory Board. The Nezus have been instrumental in guiding us through the cultural landscape of Japan, and helping us foster relationships in Japan and beyond.

While the Nezus may live across the Pacific, like us, they have a deep understanding of the broader impact of Portland Japanese Garden. The Garden has the power to heal. 60 years after its inception, we've seen Portland Japanese Garden go from the target of intolerant hostility, to one of Portland's most beloved cultural institutions. It is a place that people seek in times of celebration and in times of mourning, and has compelled countless people from all corners of the world to visit. As a result, the Garden continues to connect

people, communities, and cultures and its lessons inspire others to apply the concept of a Japanese garden to bring solace and respite.

As we approach Asian American Native Hawaiian/Pacific Islander (AANHPI) Month in May, I am proud to represent an organization that exposes our visitors to a culture that might otherwise feel foreign. This exposure to cultures, customs, and ideas different than one's own, is critical in attaining a harmonious relationship with each other. As Portland Japanese Garden members, I hope you also find meaning and value in being a part of something bigger than oneself. Through this strong sense of community and shared experiences, we can make a positive social impact.

With gratitude,

Steve Bloom  
Chief Executive Officer



# Member News & Events

## Annual Meeting of the Membership

April 24 / 5:30 - 8:30 pm

Join us for the Annual Membership Meeting on Monday, April 24th. Our CEO, Steve Bloom, will give an annual overview for members and will present about the organization's future. Special to this year's Annual Meeting, the reception will include a ceremony in which our original entry gate will receive its official name: the "Nezu Gate." Our guest speaker is Dr. Joshua Walker, President and CEO of Japan Society.

*This is a member-only event.*

To register, go to [japanesegarden.org/annualmeeting2023](https://japanesegarden.org/annualmeeting2023)

## Kodomo no Hi, Children's Day

May 7

Kodomo no Hi, also called Children's Day, is celebrated each year in Japan in early May to celebrate the growth and good fortune of children. Come celebrate the beloved family tradition at Portland Japanese Garden! A range of family-friendly activities will be available for kids of all ages. For more information, go to [japanesegarden.org/childrensday2023](https://japanesegarden.org/childrensday2023)

## Monthly Mindfulness Tours

May 21 / 9:00 am

Starting in May, monthly Mindfulness Tours for members only will return. These intimate tours focus not on meditation, but instead on learning to bring mindful awareness to oneself, and the world around us, through intentional observation and connections. An experienced guide will provide a foundation of the art of contemplative exploration throughout various Garden spaces, and gently guide awareness away from the business of everyday life, back toward the connection to nature and experience of peace. Each tour will also be slightly unique and tailored to the current season. Tours will begin in the Atsuhiko and Ina Goodwin Tateuchi Foundation Courtyard starting at 9:00am, and typically last about 45-60 minutes.

Space is limited, so reservations are required. Full details and access to reservations can be found on [japanesegarden.org/events](https://japanesegarden.org/events)

## Transition to Electric Leaf Blowers

Portland Japanese Garden is committed to being a steward of our shared natural environment. In response to member feedback as well as Multnomah County's recent vote to transition our county's leaf-blowers from gas-powered to electric models, the Garden will be making a gradual transition to electric leaf blowers, which will reduce greenhouse gas emissions and noise pollution. We may still need to use gas-powered leaf blowers when there is a larger and heavier volume of leaves in autumn.

 Jonathan Ley





 Don Schwartz

## Asian American Native Hawaiian/Pacific Islander Heritage Month Events

AANHPI Heritage Month is a time to reflect upon and celebrate the remarkable role of the AANHPI community in our nation’s history. Founded in 1963 to heal the wounds of World War II, Portland Japanese Garden is proud to represent this community and exist as a place that can continue to inspire harmony and peace.

### Oregon Rises Above Hate Celebration

May 6 / 10:00am

Oregon Rises Above Hate (ORAH), a collection of community leaders who want to defeat anti-Asian hate by harnessing the power of the entire Asian American Native Hawaiian/Pacific Islander (AANHPI) community and all Oregonians statewide, will be holding a celebration event at Flanders Festival Street in Old Town. Portland Japanese Garden will be there, so make sure to come by! For more information go to [oregonrisesabovehate.com](http://oregonrisesabovehate.com)

### Lecture: Finding Solace in the Soil

May 12 / 3:00 – 4:30pm

Dr. Bonnie J. Clark, a professor at Denver University and Curator for Archeology of the DU Museum of Anthropology will discuss how wrongly incarcerated Japanese Americans transformed the hostile landscape of their Amache, Colorado concentration camp into gardens during World War II. This talk will be held in the Jordan Schnitzer Japanese Arts Learning Center, followed immediately by a book signing. Dr. Clark’s book will be available for purchase.

### Free! Music in the Garden

May 17 / 1:15 – 6:15pm

In solidarity with AANHPI Month and in partnership with Oregon Symphony, Portland Japanese Garden will be hosting an afternoon of performances celebrating Asian and Asian American composers, musicians, and culture. This concert will be free to Garden members and the public (with purchase of general admission) and will feature multiple performances throughout the afternoon.

## Mark Your Calendars: Summer Extended Member Hours

May 18 & May 31 / 7:00 - 9:00 pm

Special Extended Hours for members return starting in May! Take advantage of the extended light of summer and enjoy quiet evenings at the Garden. Advance reservations are not required, and member guests are welcome. Details for additional extended hours can be found on our website, [japanesegarden.org/events](http://japanesegarden.org/events).





📷 Asian Pacific Family Club

## The Healing Power of a Garden: Oregon State Penitentiary's Memorial Healing Garden

### The Communal and Individual Endeavor of Healing

In late February, members of Portland Japanese Garden's Garden Department traveled south to Salem, Oregon. In the unadorned part of the state capital they arrived to, brown and gray buildings loom over grassy patches, bare-limbed trees, roads, and parking lots. It was a radical departure from the serene and verdant landscape that Portland Japanese Garden's gardeners tend. They were here to see the Memorial Healing Garden, a nearly 13,000-square-foot plot of land in front of cellblock C at Oregon State Penitentiary (OSP). Beyond this garden's fences is a prison tableau most would imagine from the popular culture they've consumed: large expanses of asphalt, looming towers, and barbed-wired fences. But the garden within is an entirely different story.

With winding paths, pines, raked gravel, a wooden bridge, and a pond filled with koi, it hearkens back to many of the most cherished qualities of Portland Japanese Garden. The Memorial Healing Garden and Portland Japanese Garden share a connection in that they feature the work of Hoichi Kurisu, a world-renowned Japanese landscape expert and Portland Japanese Garden's second Garden Director (1968-73).



The Memorial Healing Garden is the product of the planning, fundraising, and volunteer work of 200 adults in custody at Oregon State Penitentiary, in collaboration with 75 community supporters and administrative support from the Oregon Department of Corrections. Established in 2019, over \$500,000 in monetary and in-kind donations were privately raised. Similar to how Portland Japanese Garden is not funded with tax dollars, neither was the Memorial Healing Garden.

“The concept of healing gardens for incarcerated populations is inspirational,” said Hugo Torii, Garden Curator of Portland Japanese Garden. “I wanted the Garden Department to visit this space to gain more perspective on the impact of gardens. Sometimes to be soaked in wilderness provides a reset for humans. Sometimes a single flower on a dining table can give us a similar effect. Gardens provide something in between. While we’re in the midst of the day-to-day maintenance and sustainability of Portland Japanese Garden, I wanted my team to experience this impact on a personal level, away from familiar ground.”

Just as Portland Japanese Garden’s maintenance is maintained through a combination of longtime practitioners and beginners, the Memorial Healing Garden was created through a combination of experts and newcomers: Kurisu and the adults in custody who have joined and lead OSP’s Asian Pacific Family Club (APFC).

A key figure in the construction of the Memorial Healing Garden was Toshio Takanobu, former President of the APFC and an individual whose sentence was commuted by former Oregon Governor Kate Brown. Governor Brown specifically referenced his work in the garden when explaining her decision. For Takanobu, it was a transformative experience.

“The overall experience [at OSP] and especially at the Healing Garden made me recognize more about humility and value community and understand how to be in service—helping others while also helping yourself,” Takanobu shared while discussing his future. “I’m pursuing certification in welding to add more skills and maybe potentially I can utilize these skills in creating sculptures that aligns with Japanese gardens. The other thing that I’m doing is I’m enrolled in a certified recovery mentor specialist program. They will give me certification credentials to be a ‘peer support mentor.’ Those past three years at OSP that’s all we have been learning to do—utilizing the Healing Garden as peer support, helping guys from mental health units and the ones transitioning to the general population.”

“Being connected to nature heals us,” reflects Torii. “I hope to continue to explore and experience the potential of gardens and garden spaces for years to come.”

To read the full article go to  
[japanesegarden.org/OSP](http://japanesegarden.org/OSP)

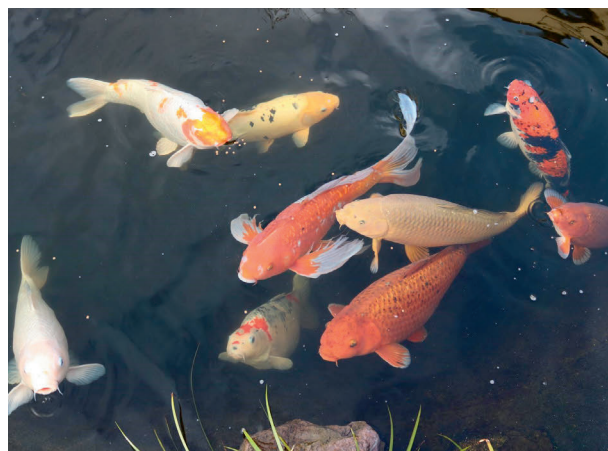



## A Reminder of Peace and Reconciliation

Portland Japanese  
Garden's First Garden  
Director Shares Experiences

Over the course of 60 years, Portland Japanese Garden's landscape has been overseen by eight Garden Directors and two Garden Curators. The first Garden Director was Kinya Hira (1964-69) who worked directly with the Garden's original designer, Professor Takuma Tono of Tokyo Agricultural University. Hira's time in Portland was a combination of triumphs and tragedies. Living on our grounds in a small trailer with his dog Hana, Hira worked tirelessly day and night to help create the Garden we all know and love today. However, his tenure was fraught with verbal abuse and physical attacks, a searing kind of racism that has been diminished in Portland, thanks in part to Hira's work to create a place where people from different cultures could come together and learn from each other. On the next page, we have a letter Hira wrote in 2017, something we turn to often when thinking about those early years in Portland Japanese Garden.



Above, upper: Garden Director Kinya Hira, seen in 2010. 📷 Jonathan Ley

Above, lower: Kinya Hira (l) seen in front of the Tea House during its construction.

📷 William 'Robbie' Robinson

Opposite, upper left: Kinya Hira. 📷 City of Portland (OR) Archives, A2011-002.188

Opposite, upper right: Hira building the Flat Garden. 📷 William 'Robbie' Robinson

Opposite, lower right: Garden Director Kinya Hira (R) looks at his successor, Hoichi Kurisu, as they work on the inner path of the Flat Garden. 📷 William 'Robbie' Robinson



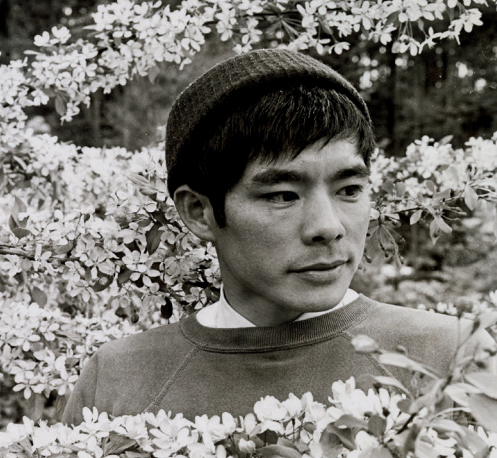

## A letter from Kin'ya Hira:

“Portland Japanese Garden may mean different things to different people. For some visitors, it may be a place to relax and learn about the Japanese culture, or a place of fond memories with a sweetheart. For some directors, the Garden may be like their precious child who they cared for and proudly watched grow into a beautiful princess.

That is when I asked myself, “What does the Garden mean to me?” As the first director, what does this Garden symbolize to me personally? And I have concluded that to me, this Garden is a reminder of peace and reconciliation. A symbol that the City of Portland has the heart to forgive and accept foreign cultures. These are the virtues that this great nation was built upon.

At first, I was hesitant to tell this story. But I am 80 years old now. I feel it's my duty to be honest about what happened in the early 1960s. It was 1964 when I first came to this beautiful city of Portland with Professor Tono. And not too many people know that there was harsh opposition in the beginning. During the initial phase of the construction, hate groups gathered at the site, and chanted racial slurs at me. I was even hospitalized one time when I attempted to stop a group vandalizing the garden. When I confronted them, I quickly understood that this anger came from the war. I remember one man yelling, “you killed my father.” That's when I realized that this Garden, to some, may have reminded them of their loved ones who were lost in the war.

And who can blame them? It had only been 20 years since that horrible war. Both sides lost precious families and loved ones in that war. And now, just because the government says so, we must be friends again? That is just too much to ask of a human. And now, we are building a Japanese garden on American soil? Of course there will be opposition.

However, as weeks turned into months, the sentiment started to shift. Little by little, people would support me and the Garden. They started to see and understand what I was trying to do here. The people of Portland found something in their hearts to forgive and accept; to let go of the anger and begin to reach out. I remember one time when the same hate mob came to the site, my supporters actually fought them off, protecting me and the Garden. For the first time in America, I didn't feel alone, I felt accepted by the people of Portland.”

To read the rest of Hira-san's letter, go to [japanesegarden.org/hira](http://japanesegarden.org/hira)  
For a collection of stories on our history, go to [japanesegarden.org/60-years](http://japanesegarden.org/60-years)

## 60th Anniversary Special Story

As part of our 60th anniversary, we'll be highlighting a different element of our history in every issue of *The Garden Path* in 2023!





*L-R: Former Consul General of the Consular Office of Japan in Portland, Masaki Shiga, Chief Curator Sadafumi Uchiyama, Curator Emerita Diane Durston, and CEO Steve Bloom at a 2022 event in the Garden celebrating Uchiyama and Durston's awards. 📷 Nina Johnson*

## Portland Japanese Garden Leaders Feted with High Honors from Japanese Governmental and Cultural Organizations

Curator Emerita, Chief Curator, and CEO Recognized

Portland Japanese Garden's ascendancy from an idea to becoming the most beautiful and authentic Japanese garden outside of Japan and preeminent Japanese cultural organization in North America is due in large part to it having been under the stewardship of a succession of experts and leaders. These individuals have been routinely recognized for their efforts by the Japanese government and prestigious Japanese cultural organizations and elevate the Garden to world-class standards.





### Order of the Rising Sun, Gold and Silver Rays: Diane Durston, Curator Emerita

Diane Durston, who served Portland Japanese Garden as its Arlene Schnitzer Curator of Culture, Art, and Education from 2007 to 2018, is a world-renowned expert on Japanese culture, and highly regarded author of several books about Kyoto and more. Now the Garden's Curator Emerita after her 2018 retirement, Durston was awarded the Order of the Rising Sun, Gold and Silver Rays. This award was established in 1875 by Emperor Meiji and is among the highest honors conferred to civilians. The Consular Office of Japan in Portland shared that Durston was chosen "in recognition of her contributions to the introduction of Japanese culture in the United States, and to the promotion of mutual understanding between Japan and the United States."

📷 Nina Johnson



### Foreign Minister's Commendation: Sadafumi Uchiyama, Chief Curator

Sadafumi (Sada) Uchiyama, Chief Curator of Portland Japanese Garden and Director of the International Japanese Garden Training Center at Japan Institute, is a fourth-generation Japanese gardener who is a multiple award-winning landscape architect, and acclaimed practitioner whose work has influenced the design of gardens across the United States. Uchiyama was awarded the Foreign Minister's Commendation from the Foreign Ministry of Japan. The Consular Office wrote that this honor is given to individuals "who have made particularly remarkable achievements in various fields of international relations, and who have contributed significantly to the promotion of friendly relations between Japan and other countries."

📷 Nina Johnson



### Kaneko Kentaro Award: Steve Bloom, CEO

Steve Bloom, CEO of Portland Japanese Garden since 2005 and CEO of Japan Institute since its establishment in 2020, has been awarded by multiple Japanese and American institutions and is a sought-out expert on nonprofit leadership. Bloom was presented with the Kaneko Kentaro Award. The honor, referred to as the Kaneko Award, was established by the America-Japan Society in 2017 to commemorate the 100th anniversary of its founding. The America-Japan Society cheered Bloom writing he has, "served selflessly and impartially in other non-profit, academic, and sister city/friendship city exchanges" and "has made a significant contribution to building the status of Japanese garden culture in the world."

📷 Nina Johnson

# Looking Ahead to the Japan Institute Campus



## ARTIST COTTAGE DUPLEX

Built in 1956, this one-story home has five bedrooms and can be neatly divided into two private homes. Originally built to house nurses who worked here when it was known as The Salvation Army's White Shield campus, it will become available to Japan Institute's Artists-in-Residence and their families for extended stays.

B

## ARTS & ADMINISTRATIVE CENTER

Built in 1914 and designed by one of Portland's most important and prolific architects, A.E. Doyle, the Arts & Administrative Center will have a full-service kitchen, dining hall, staff offices, classrooms, and a number of different artist work areas and classrooms that will accommodate a variety of different media, including textiles, ceramics, woodworking, and photography.

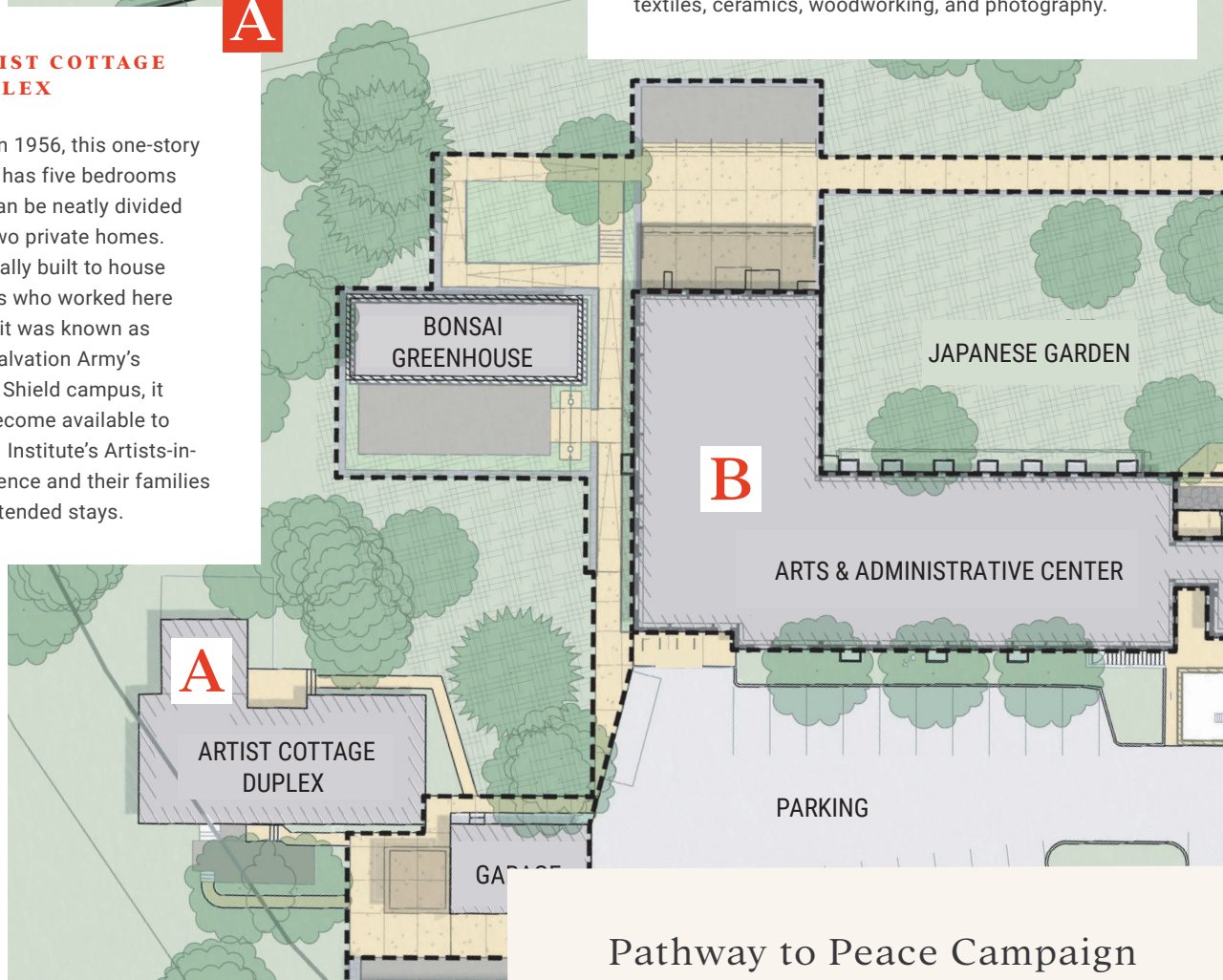

Pathway to Peace Campaign





Japan Institute’s physical campus near Forest Park is currently in its design-build process in collaboration with our architect on record, CIDA, a woman-owned architecture and design firm. The team for the project includes Precision Construction, Walker Macy, and Kengo Kuma & Associates. Japan Institute hopes to open its campus in the second half of 2025. Below is a concept map made by landscape architecture firm, Walker Macy, that will help illustrate how this incredible space will come to life when all phases of its build-out have been completed.

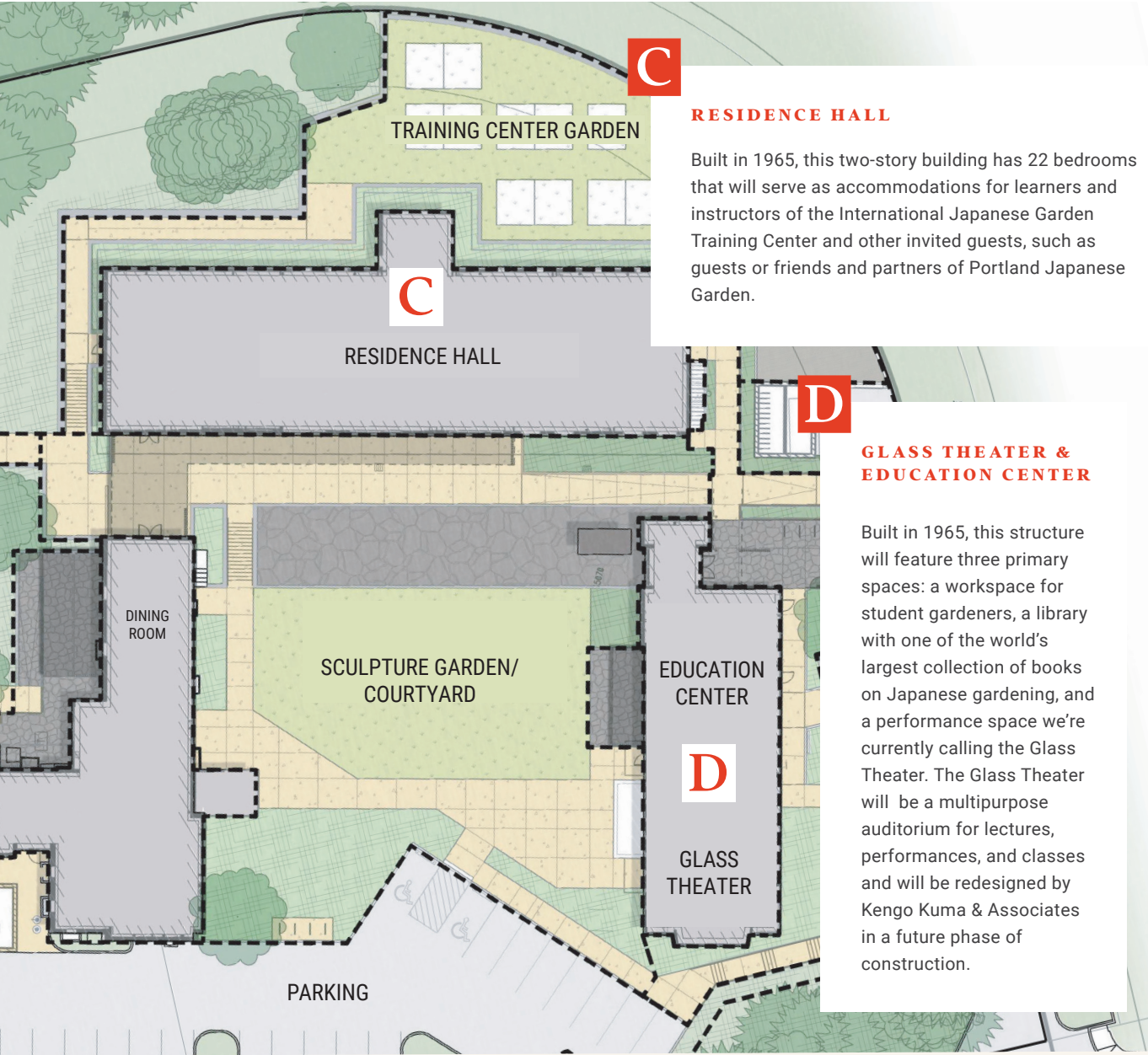

**RESIDENCE HALL**

Built in 1965, this two-story building has 22 bedrooms that will serve as accommodations for learners and instructors of the International Japanese Garden Training Center and other invited guests, such as guests or friends and partners of Portland Japanese Garden.

**GLASS THEATER & EDUCATION CENTER**

Built in 1965, this structure will feature three primary spaces: a workspace for student gardeners, a library with one of the world’s largest collection of books on Japanese gardening, and a performance space we’re currently calling the Glass Theater. The Glass Theater will be a multipurpose auditorium for lectures, performances, and classes and will be redesigned by Kengo Kuma & Associates in a future phase of construction.

Japan Institute is currently in Phase One of its Pathway to Peace Campaign, which is seeking to accomplish the renovation of its Arts & Administrative Center, Residence Hall, and Education Center, including the creation of purpose-built classroom for teaching Japanese art forms. This phase also includes construction of a workspace for the International Japanese Garden Training Center, parking expansion, and laying groundwork for future improvements including a bonsai greenhouse and sculpture garden. The purchase of the property along with the renovation and programming for Japan Institute is made possible by generous Garden donors and fundraising is still ongoing, with \$17.5 million raised toward our goal of \$30 million. You can support Japan Institute by reaching out to our Director of Philanthropy, Claire Eisenfeld, at [ceisenfeld@japanese garden.org](mailto:ceisenfeld@japanese garden.org) or (503) 542-0281.



David M. Cobb



To see this list online, go to  
[japanesegarden.com/support-your-garden](http://japanesegarden.com/support-your-garden)  
 For corrections, contact  
[development@japanesegarden.org](mailto:development@japanesegarden.org)

Cumulative giving to the Annual Fund from December 1, 2021 through January 31, 2023

Global Ambassadors, our members and donors residing more than 120 miles from Portland, Oregon, are recognized with a globe icon next to their name. 🌐

**\$100,000+**

State of Oregon

**\$50,000 - \$99,999**

Lani McGregor & Daniel Schwoerer  
 Dorothy Piacentini

**\$25,000 - \$49,999**

Jean & Ray Auel  
 Bank of America 🌐  
 Emerio Design  
 Institute of Museum & Library  
 Services 🌐  
 Japan Foundation New York 🌐  
 Joto Sake 🌐  
 Maybelle Clark Macdonald Fund 🌐  
 Oregon Community Foundation  
 Travers & Vasek Polak  
 Schommer & Sons  
 Torii Mor Winery & Vineyard  
 Robert & Deborah Zagunis

**\$10,000 - \$24,999**

Carole Alexander  
 George & Patty Beall  
 Chita Becker  
 The Bidwell Portland  
 Jack B. Blumberg  
 Mary Lee Boklund  
 Teresa Chiu & Jeffrey Livingston  
 Conrad Clark  
 Dede & Joe DeJager  
 Delta Air Lines 🌐  
 Mrs. Margueritte H. Drake & the  
 Margueritte Hirschbuhl Drake  
 Fund, OCF  
 Yoko Fukuta  
 Sally G. Gibson 🌐  
 William G. Gilmore Foundation 🌐  
 Jon & Yoko Greeney  
 Jenny Herman 🌐  
 Janie & Gary Hibler  
 Hillman Family Foundation 🌐  
 Hoffman Construction  
 Hyatt Regency  
 J.W. & H.M. Goodman Family  
 Charitable Foundation  
 John & Janet Jay  
 Juan Young Trust  
 The Lora L. & Martin N. Kelley  
 Family Foundation Trust  
 Nikki & Yoshio Kurosaki and  
 the Kurosaki Family Fund, Oregon  
 Jewish Community Foundation  
 Martin Lotti & Linda Mai-Lotti  
 The Maas & Marglous Family  
 Janet & Tom Montag  
 Multnomah Whisk(e)y Library  
 Nike  
 Oregon Heritage Commission  
 Mary & Alex Polson  
 Jordan Schnitzer

Yoneko Shimizu-Dalton  
 Drake & Lynn Snodgrass and  
 Drake's 7 Dees  
 Mark Stell & Michelle Harstrom and  
 Portland Coffee Roasters  
 Dorie & Larry Vollum and the Jean  
 Vollum Fund of the Vanguard  
 Charitable Endowment  
 Anonymous (4)

**\$5,000 - \$9,999**

Ruth Anderson & Michael Beebe  
 Bartlett Tree Experts  
 Martha & Anthony Belluschi  
 Priscilla Bernard Wieden  
 Mrs. Suzanne Storms Berselli &  
 Dr. Robert Berselli  
 Elizabeth "Ibby" Brooke  
 Brown Printing Inc.  
 Bullseye Glass Co.  
 Jennifer Castillo  
 Sandra Chandler & Chris Schaefer  
 Mora Chartrand & Linda Grant  
 Chef Naoko  
 Deborah & Jim Coonan  
 Creco Chocolate  
 Devil's Food Catering  
 Douglas & Bee de Weese  
 Julie & Wayne Drinkward  
 Bart & Jill Eberwein  
 Susan & Greg Fitz-Gerald  
 Katherine & Mark Frandsen  
 Carol Frankel  
 Bob & Jeanne Frasca Fund, Oregon  
 Community Foundation  
 Donald Gibson 🌐  
 Susan & Tom Hamman 🌐  
 Mrs. Ronna Hoffman  
 Tatsuo Ito & Kohgetsu Aoki and  
 SEH America, Inc.  
 Salena Johnson  
 Allan Karsk & Keith Berglund  
 Elizabeth M. King  
 Naoki Kuze & St. Cousair  
 James D. Lynch &  
 Robby Cunningham 🌐  
 Susan & Peter Lynn  
 Lisa Maulhardt & Joseph Okies, Jr. 🌐  
 Kelly & Steve McLeod  
 Mercer Advisors  
 Chris & Tom Neilsen and the Neilsen  
 Family Fund, Oregon Community  
 Foundation  
 NW Natural Gas Co.  
 The Oregonian  
 Marianne Perrin  
 Port of Portland  
 William & Anne Rasnake  
 Gary & Sue Reynolds  
 Marge Riley Fund, Oregon Community  
 Foundation  
 Trudy & Pat Ritz, Ritz Family  
 Foundation  
 Cathy & Jim Rudd  
 Paul & Caitlin Schommer  
 Michael Speight & Myunghye Han  
 The Standard

Pamela Still  
 Storms Family Foundation  
 Drs. Mayho & Calvin Tanabe  
 Dona & John Tarpey  
 Treecology, Inc.  
 Hiro Tsuji & James Knodell 🌐  
 Zachary Vinton  
 Liz & Bob Warren  
 Carmen Wong & Arjun Chatrath  
 Yamato Transport USA, Inc. 🌐  
 Joji Yoshimura & Michael Kronstadt  
 Anonymous (3)

**\$2,500 - \$4,999**

Trish Adams  
 Roudabeh Akhavein  
 John Benson & Virginia Tilden  
 Janice Bleibaum  
 Evona Brim  
 Broughton & Mary Bishop Family  
 Foundation  
 Diane & James Burke  
 Eric & Robin Busch  
 Stephen Chipps & Laura Sherrill  
 James Cox & Brenda Nuckton  
 Anne & James Crumppacker  
 George Cummings  
 Danziger Family Foundation, The  
 Chicago Community Foundation  
 Diane Dimer  
 David & Beth Ferguson  
 Kelley Forseth & Clarity Consulting  
 Geffen Mesher  
 Barbara Giesy  
 Peter & Mim Gray  
 Sandra & Jeffrey Grubb  
 Margaret Hacker  
 Ms. Susan Halton and the  
 Halton Foundation  
 Merle & Andrew Hashimoto  
 Mike Henningsen Fund, Oregon  
 Community Foundation  
 Kerstin & Joshua Husbands  
 The Jackson Foundation  
 Edwina & Victor Kane  
 Catherine & John Knox  
 Ross M. Lienhart, Edward Lienhart  
 Family Foundation  
 Joyce & Stanley Loeb  
 Kathy Lou  
 Curtis W. Marble 🌐  
 Glenn Moore  
 Lindley Morton & Corinne Oishi  
 Anne Naito-Campbell  
 Obon Shokudo  
 The Paramount Hotel  
 Park Lane Suites and Inn  
 Shirley & David Pollock  
 Pushdot Studio  
 Russell & Mary Reid  
 Room & Board  
 Laura Schlafly  
 Susan Schnitzer & Greg Goodman  
 Mary Sharman & Mitchell Sundquist  
 Martha Sharman &  
 John Warren Reid Jr.  
 Peter Shinbach





Portland Japanese Garden

Steven H. Smith & Dennis C. Johnson  
SN Charitable Foundation  
Ernie Stoddard  
Charles J. & Caroline Swindells  
Charitable Fund, Oregon Community  
Foundation  
Deborah Thomas & Betty Curtis  
Cathy & Greg Tibbles  
Miriam C. Trahan  
Susan & John Turner  
Alice & Wim Wiewel  
Susan & Jim H. Winkler  
Lynn & Jeffrey Wolfstone  
Anonymous (2)

\$1,500 - \$2,499

Abbott Laboratories  
Abbie Inc.  
Acorn Fund, Oregon Community  
Foundation  
Sally Adkins & William Bostian  
Ravinda Ahluwalia & Kavleen Sahni  
Susan & Dean N. Alterman  
K. Andreasen  
Julieann & Alan Barker  
Randy & Kim Boehm  
Renee Carisio-Farber & Jeffrey Farber  
Will Carter & Jeff Miller  
Candy Cassarno  
The Chicago Community Foundation  
Tim & Lisa Christy  
Kathryn & John Cochran  
Jonah Cohen  
Truman Collins  
Julia Dancy  
Cameron & Dick Davis  
Mary Dickson  
DLR Group  
Kristen A. Dozono  
Karen & Jonathan Dunn  
Gail Durham & E Benno Philippson  
Marilyn Easley, in memory of  
David Easley  
Rodger Flint  
Flowerree Foundation

Mikiko Flynn  
Judith Free & Paul Hamborg  
Diane & Gary Freeman  
Steve & Peggy Garber  
Andra Georges & Timothy Shepard  
Karl & Shelagh Glaser  
Ann Goetcheus  
Howard Greisler  
Marianna Grossman  
Bruce Guenther &  
Eduardo A. Vides, M.D.  
Hacker Architects  
Mr. & Mrs. Frank Halvorsen  
Cynthia & Andrew Haruyama  
Etsuko Harvey  
Hasegawa Kogyo Co., Ltd.  
Don Hastler & Dan Bergsvik  
Jay A. Henry & Demi Haffenreffer  
Helen Herman  
Philip Hoefer  
Mary & Gordon Hoffman  
Mara Hook & Steve Polkow  
Tomoe Horibuchi & Kihachiro Nishiura  
Elizabeth Hulick & Mark Handley  
Lois Jackson  
The Jasmine Pearl Tea Company  
Janelle & Lee Jimerson  
Bradford Johnston & Julie Evans  
David Katz & Lee Katman  
Aase Kendall  
Jane R. Kendall Family Fund, Oregon  
Community Foundation  
Peter J. Kendall  
Selby & Douglas Key  
Bonnie Laun  
Polly & Ron Lauser  
Elizabeth Leach & Bert Berney  
Megan & Ralph Leftwich  
Patricia T. Leiser & Gary Leiser  
Doug & Theresa Lovett  
saRah Mahler  
Mark Spencer Hotel  
Anthony & Erin Kelly Masciotra  
Tim Mather  
Janet McCormick & Stephanie Walker  
Patricia & Steven McNeal  
Allen Mercer & Helen Angelica Wong

Erin Moeschler & Robb Rathe  
Bruce & Jeanette Morrison  
Multnomah County Cultural Coalition  
John & Nancy Murakami  
Mrs. Hester H. Nau & Leslie Willhite  
Lynne Naughton  
Oregon Cultural Trust  
Oregon Venture Fund  
James H. Peters & Hitomi Tamura  
Jason Pflugstmann  
Frank Piacentini & Sara Weinstein  
James Prihoda & Julia Tank  
Kimberly & Stan Prosser  
Wayne M. Quimby &  
Michael Roberts-Quimby  
Lee & Ronald Ragen  
Susan & Michael Rego  
Pat Reser  
Nancy L. Richmond &  
William A. Hughes  
Nan Robertson  
Valerie Sasaki  
Janet Schibel  
Scott & Charlene Schneier  
Patrick Simpson & Margaret Bolger  
Sudha & Siva Sivakumar  
Sylvia Skarstad  
Marie & Thomas Spence  
Dawn M. States & Stephen Smith  
E. Kay Stepp  
Tarbell Family Foundation  
Rebecca & Russell Teasdale  
Richard Testut, Jr. &  
Dr. Marilyn Rudin, MD  
Connie & Tom Thomsen  
Rena & Cheryl Tonkin  
Hugo & Akiko Torii  
Robert Trotman  
Dawn & Sadafumi Uchiyama  
Vista Capital  
David Willis  
Bess Willis  
Richard & Ellen Wopat  
Danny Wu  
Suzanne & Craig Zarling  
Anonymous (2)

Thank you



If you would like to make a donation or have any questions about the Golden Crane Society, please contact Claire Eisenfeld, Director of Philanthropy, at (503) 542-0281 or [ceisenfeld@japanesegarden.org](mailto:ceisenfeld@japanesegarden.org).

David M. Cobb





📷 David M. Cobb

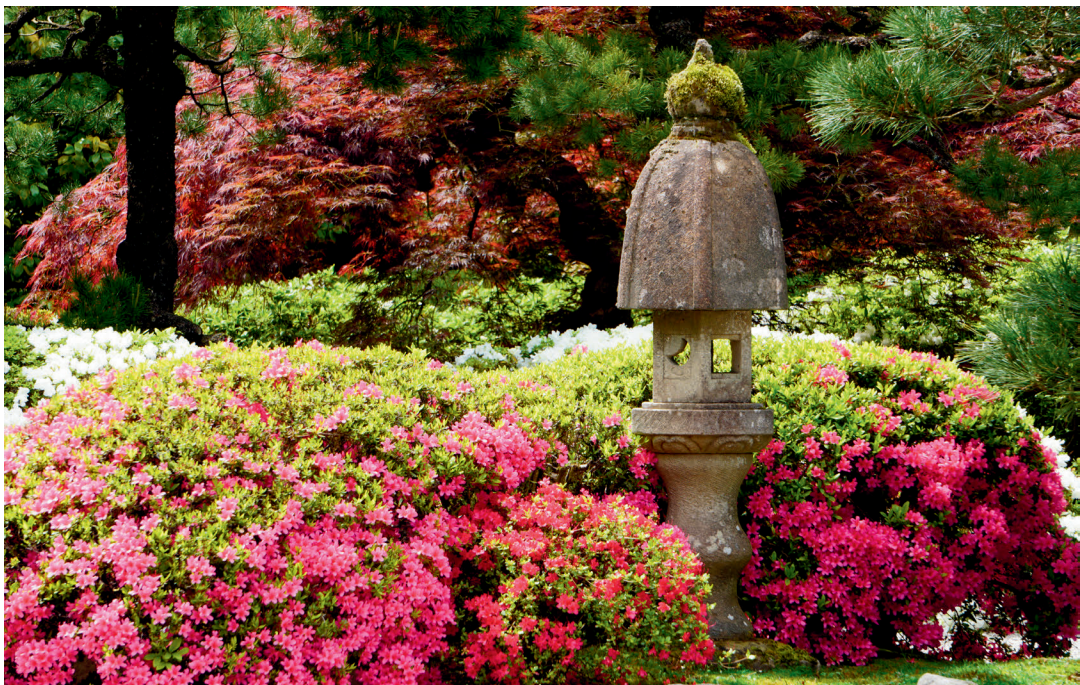

📷 Portland Japanese Garden

## PHOENIX LEGACY SOCIETY



If you would like to include the Garden in your estate plans, or if you have already done so and would allow us to list you as a Legacy Society Member, please contact Claire Eisenfeld, Director of Philanthropy, at (503) 542-0281 or [ceisenfeld@japanesegarden.org](mailto:ceisenfeld@japanesegarden.org).

Members of the Phoenix Legacy Society have named the Garden as the ultimate beneficiary of a planned gift. We are grateful to the following people for letting us know of their plans to support the Garden in this enduring way.

Ruth Anderson & Michael Beebe  
Esther "Ricky" Appleman  
Carole Beauclerk  
Barbara Bell  
Diane Benjamin  
Melanie Billings-Yun  
Steve Bloom  
Judy Bradley & Dave Mitchell  
Susan C. Brown  
Carla Caesar & Nora King  
Robert Caragher  
Mora Chartrand & Linda Grant  
Teresa Chiu & Jeffrey Livingston  
Mary Dickson  
David & Nancy Dowell  
Mrs. Margueritte H. Drake  
Elaine West Durst  
Doyle Forister and Gary Sheldon  
Yoko Fukuta  
Ms. Susan Halton  
John Hembroff & Shari Macdonald  
Ron & Jenny Herman  
Geoffrey Hoefer  
Albert Horn

Ann & Jerry Hudson  
Janelle Marie Jimerson  
Mary Kay Johnson  
Elizabeth M. King  
Valerie Lau  
Ron & Polly Wall Lauser  
John & Lisa Lehman  
Patricia Locktov  
Linda & Don McNeill  
Gordon Olson  
Jeannie & Ron Prindle  
Wayne M. Quimby &  
Michael Roberts-Quimby  
W. Curtis Schade &  
Jacquie Siewert-Schade  
Michele & Douglas Shapiro  
Richard C. Stetson Jr.  
Ernie Stoddard  
Ann & John Symons  
Drs. Mayho & Calvin Tanabe  
Bruce & Susan Winthrop  
Carmen Wong  
Anonymous (4)



# Path for Peace Campaign for Japan Institute

Recognizing all those who have made a gift in support of our Path to Peace Campaign for Japan Institute, helping us be a leading global voice for cultural understanding, in pursuit of a more peaceful, sustainable world.

## \$1,000,000+

Jenny Herman  
State of Oregon  
Travers & Vasek Polak  
Drs. Mayho & Calvin Tanabe  
U.S. Department of Housing & Urban  
Development  
Robert & Deborah Zagunis

## \$500,000 - \$999,999

Jeanne Giordano  
Anonymous (1)

## \$100,000 - \$499,999

The Brookby Foundation  
Sandra Chandler & Chris Schaefer  
James R. Coonan, Denise C. Bates,  
& Lurline C. Menzies  
Anne & James Crumpacker  
The de Weese Family  
Bart & Jill Eberwein  
Sally C. Gibson  
Will Green & Martin Palomar  
Mrs. Ronna Hoffman

The Lora L. & Martin N. Kelley Family  
Foundation Trust  
Lani McGregor & Daniel Schwoerer  
Gary & Sue Reynolds  
Dorie & Larry Vollum and the Jean  
Vollum Fund of the Vanguard  
Anonymous (1)

## \$50,000 - \$99,999

Katherine & Mark Frandsen  
Carol Frankel  
Nikki & Yoshio Kurosaki and the  
Kurosaki Family Fund, Oregon  
Jewish Community Foundation

## \$10,000 - 49,999

Dede & Joe DeJager  
Fred Delanoy & Jane Witter  
Susan & Greg Fitz-Gerald  
Family of Lawrence R. Green  
Cathy Hitchcock  
Charles Jenkins & James Dixon, in  
memory of Marie Hooper Jenkins  
Lindley Morton & Corinne Oishi  
Shiro & Michiyo Nakane

Portland Japanese Garden Foundation  
Prime Minister's Office of Japan  
Cathy & Jim Rudd  
Sasakawa Peace Foundation USA  
Susan Schnitzer & Greg Goodman  
Drake & Lynn Snodgrass and Drake's  
7 Dees  
Dona & John Tarpey  
Dorie & Larry Vollum  
Lynn & Jeffrey Wolfstone  
Carmen Wong & Arjun Chatrath  
Woodard Family Foundation

## UNDER \$10,000

Trish Adams  
Ruth Anderson & Michael Beebe  
Mora Chartrand & Linda Grant  
Delta Air Lines  
Nick & Janet De Morgan  
William A. Hughes & Nancy  
L. Richmond  
Janelle & Lee Jimerson  
Paul Loving  
Shiro & Michiyo Nakane  
SN Charitable Foundation  
Michael Thompson  
Mr. & Mrs. Jeff Timbanard  
Alice & Wim Wiewel

# Tribute Gifts & Donations

Memorials and Honoraria  
January 1, 2023 – February 28, 2023

## GIFT IN MEMORY OF GWYNETH GAMBLE BOOTH

Travers & Vasek Polak

## GIFT IN MEMORY OF BETH BUCHANAN

Claire Buchanan & Hunter Chesnut

## GIFT IN MEMORY OF SHEILA LIENHART

Roger Cooke & Joan Cirillo

## GIFT IN MEMORY OF DAVID E. LOU

Kathy Lou

## GIFT IN MEMORY OF TOM PAYNE

Gary & Sue Reynolds

## GIFT IN HONOR OF SABINA SMITH & MICHAEL KAY

Margaret Murtagh

## GIFT IN MEMORY OF EMIKO "AMY" WILSON

Golda Dwass & Stephen Mickey  
Virginia Young

Japan Institute Artist-in-Residence Rui Sasaki stands next to her work in the Pavilion Gallery. This piece is part of an exhibition at the Garden titled, *Subtle Intimacy: Here and There*. The exhibition is funded in part by the National Endowment for the Arts.

📷 Jonathan Ley



Chief Curator Sadafumi Uchiyama gives Portland Japanese Garden members a tour in early March.

📷 Portland Japanese Garden



Special Programs Manager Yuki Wallen assists a young ikebana workshop participant during the Garden's 2023 Hina Matsuri celebration.

📷 Portland Japanese Garden

The Natural Garden's recently restored machiai. This project was made possible through the generous support of 250 donors, a matching grant from the Oregon Heritage Commission, Oregon Parks and Recreation Department, and Dorothy Piacentini.

📷 Portland Japanese Garden







*The Zig Zag Bridge blanketed in snow after the late February 2023 winter storm.*

📷 Caleb Hendrickson

*A reminder of what's to come: Looking through the Wisteria Arbor into the Strolling Pond Garden during spring of years past.*

📷 Chris Bidleman



*Members of Portland Japanese Garden's Garden Department and other colleagues alongside the Asian Pacific Family Club in the Memorial Healing Garden at Oregon State Penitentiary.*

📷 Asian Pacific Family Club

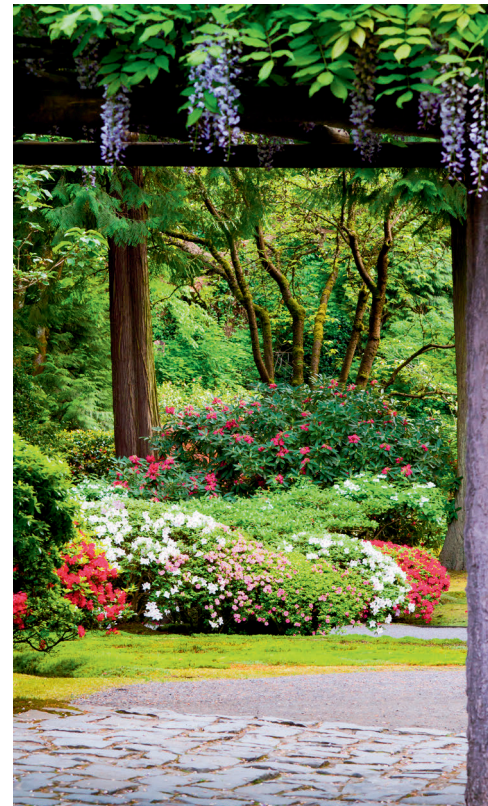

*Shiitake and Hijiki Ochazuke, a savory dish available now at the Umami Café.*

📷 Aaron Lee



The eighteen-foot Sapporo Pagoda Lantern in Portland Japanese Garden's Strolling Pond Garden was sent overseas from Sapporo, Japan in 1963. Because Portland Japanese Garden still needed time to prepare a concrete base for this two-ton lantern, it was first displayed at Portland Art Museum from March 16th to March 29th, 1964. Portland Art Museum will be the venue we celebrate our 60th Anniversary Gala on October 21st, 2023!



Official Winery of Portland Japanese Garden



Official Sake of Portland Japanese Garden



Official Airline of Portland Japanese Garden

